

ENGLISH

Tools needed



Contents of package

x1

x1



x2



a x4 2 people are recommended to fit blind on larger windows

1 Centralise Handle

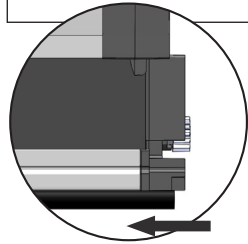

To centralise, gently slide the handle until fabric is even on both sides.

2 Fit Cassette to Top of Window Frame

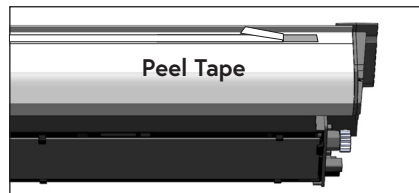

Remove the adhesive tape from the cassette.

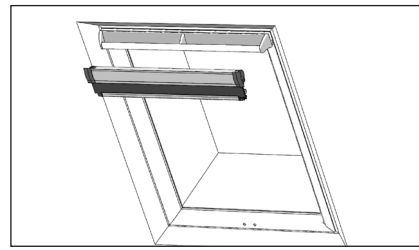

Position the cassette at top of the window frame and press firmly.

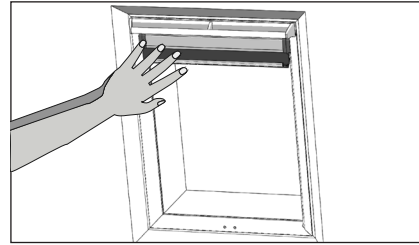

Hold the cassette in place until screws have been secured.

3 Secure Cassette

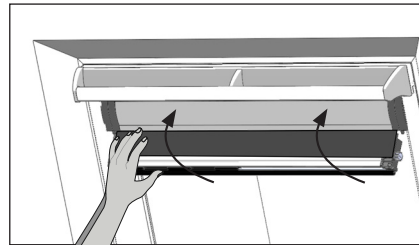

Pull handle away from the window and push upwards against the front of the cassette.

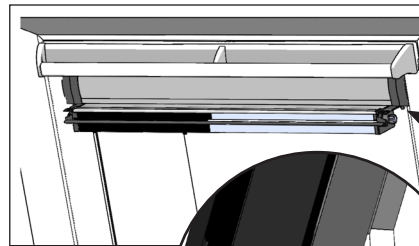

Secure the cassette using screw (a). **Repeat this process on the other side.**

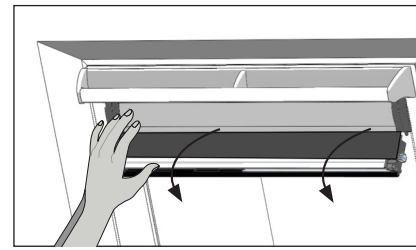
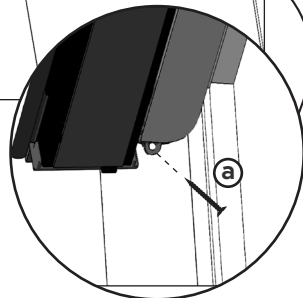

Flip handle and hold fabric flush with window.

4 Slide Siderails into Cassette

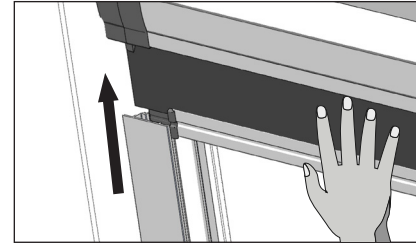

Slide fabric into the front channel of the siderail. Push siderail upwards.

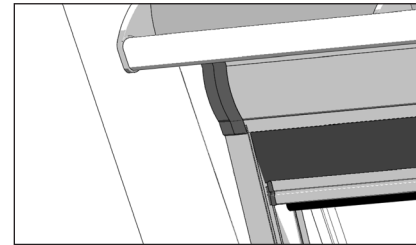

The siderail should be positioned underneath the front edge of the cassette.

5 Secure Siderails

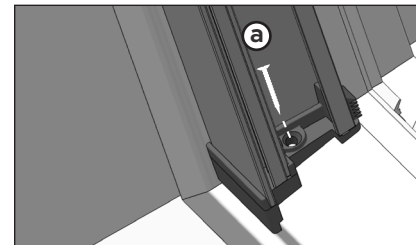

Position the siderail against the window frame and secure using screw (a) ensuring not to over tighten. **Repeat this process on the other side.**

Remote Control

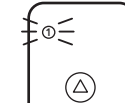
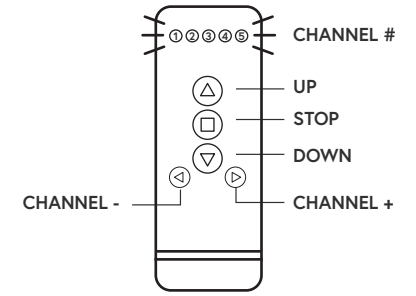

Channel number will flash once when selected.

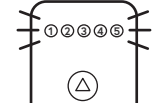

ALL CHANNELS will operate all paired blinds together.

Pairing the Remote

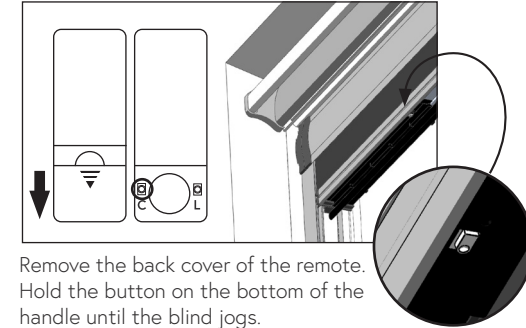

Remove the back cover of the remote. Hold the button on the bottom of the handle until the blind jogs. Hold the C button on the remote until it beeps.

Operating the Blind

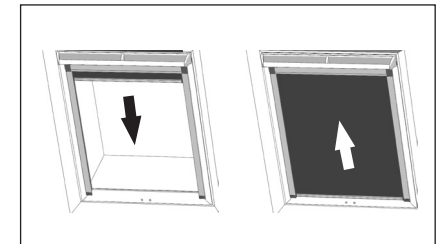

Press DOWN on the remote, the blind will stop automatically at the bottom of the window. Press UP on the remote, the blind will stop automatically at the top of the window.