



TRANSFORMING WINDOWS

Fitting Instructions

for roller blinds
(R20, Fascia, R20C, R20S, R20W)

A photograph of a long, bright office hallway with a high ceiling and large windows on the left side. The floor is highly reflective, showing the windows and the hallway's length. The windows have white frames and horizontal blinds.

Fitting Instructions

for roller blinds
(R20, Fascia, R20C, R20S, R20W)

Fitting Instructions

Roller blinds (R20, Fascia, R20C, R20S, R20W)

Safety Instructions:

1. Loops in pull cords, chains, tapes and inner cords that operate the product can cause strangulation
2. To avoid strangulation and entanglement, keep cords out of the reach of young children. Cords may become wrapped around a child's neck
3. Move beds, cots and furniture away from window covering cords
4. Do not tie cords together. Make sure cords do not twist and create a loop R20 Sidewinder control

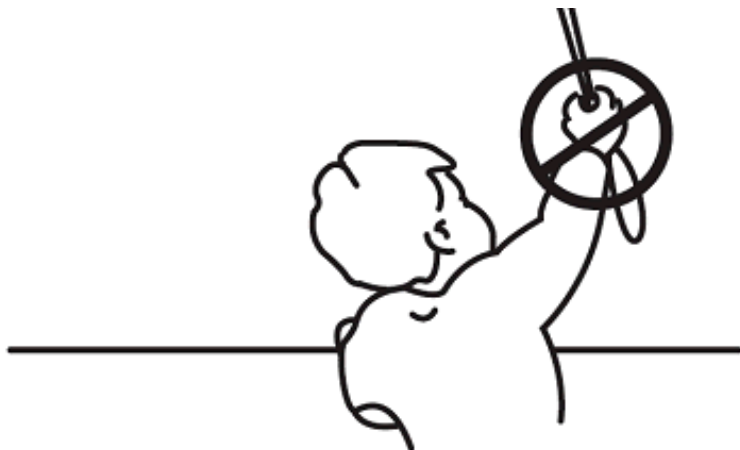

N.B. For more information and child safety device fitting instructions, see Point 7 on Page 5 & 6.

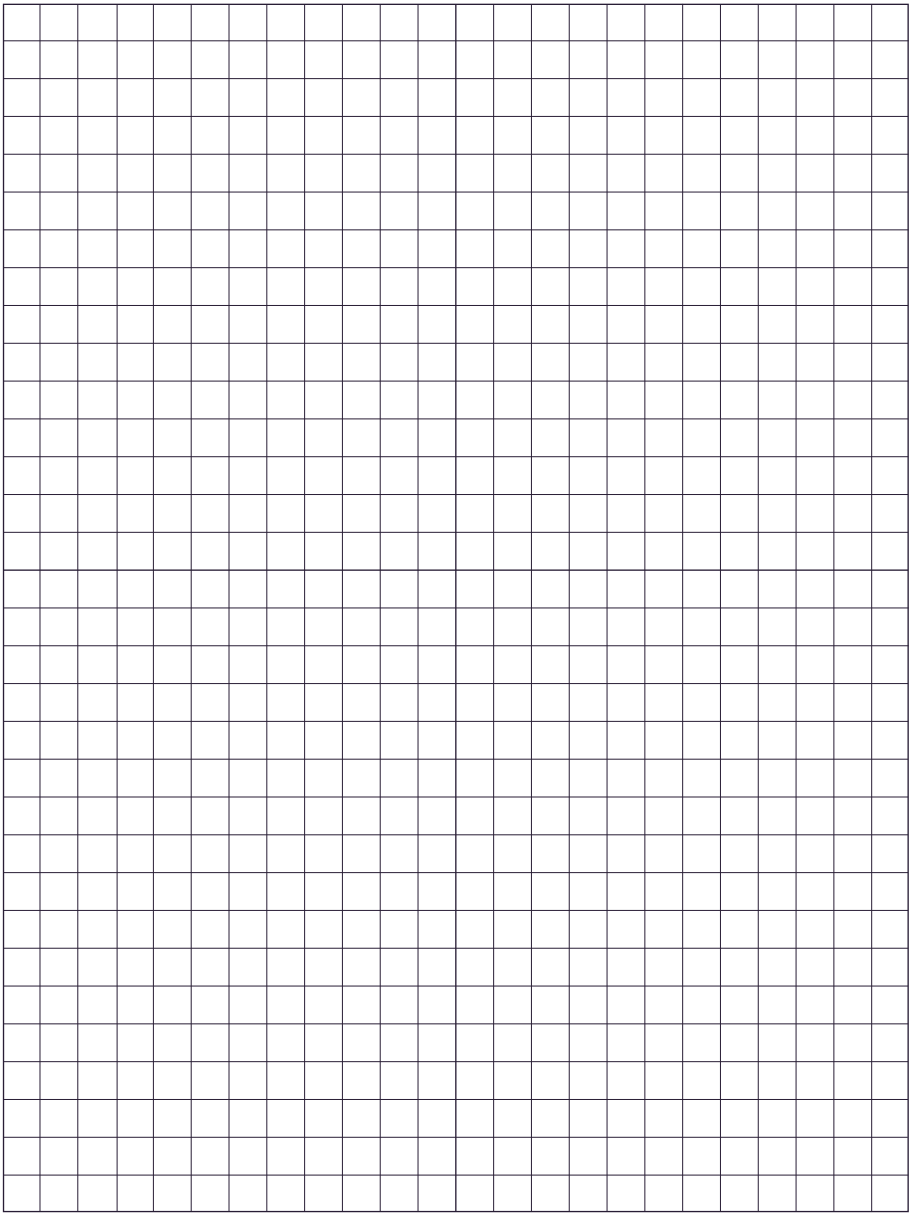

Fitting Instructions

Roller blinds (R20, Fascia, R20C, R20S, R20W)

R20 Sidewinder control:

N.B. This blind should be installed by a person competent in DIY. If in doubt please consult a professional.

1. The standard universal metal brackets supplied with the blind may be top, face or side-fixed.
2. Check that the blind fits correctly. The pin-end is sprung for easy fitting, but the pin should be depressed once in place. The fabric should roll off the back of the barrel, unless ordered reverse-roll.
3. Fix the control-end bracket using appropriate screws/plugs.
4. Locate the blind in the control-end bracket, and mark the position of the pin-end bracket.
5. Remove blind and fix pin-end bracket using appropriate screws/plugs.

NB. Fix the control-end bracket using appropriate screws/plugs.

6. Insert the pin in the pin-end of blind into the bracket. Press the blind against the bracket to depress sprung pin, and insert the lug on the control-end into its bracket until it drops into place.

7. Ensure the relevant child safety device is used to comply with BS EN13120:2009+A1:2014, BS EN16433:2014 and BS EN16434:2014 as follows:
*You will have been provided with either a chain tidy or easy break chain connector (also see page 8 & 11)

Chain Tidy

The chain tidy will be attached to the chain when the blind arrives. The chain tidy should be at a maximum distance from the control mechanism, keeping the chain taut (not under excessive tension however as this could negatively affect the longevity and operation of the blind). Put the retaining device on the wall, mark fixing holes with a pencil, drill the holes and screw the device to the wall with suitable fixings.

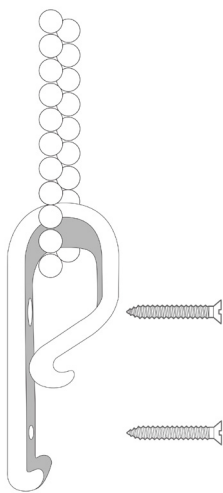

Fitting Instructions

Roller blinds (R20, Fascia, R20C, R20S, R20W)

Easy Break Chain Connectors

Two easy break chain connectors are connected to the operating chain 200mm apart. This ensures that at least one of them will be in the vertical position ensuring they perform as required. If excessive weight is applied within the loop a connector will come apart. If a connector comes apart and is undamaged then it will need to be re-connected by inserting the last ball on the end of the chain into the hole in the connector and pushed into place.



Easy break connector

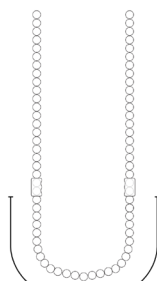

200mm apart

8. Check that the blind operates correctly.

NB. Large blinds are heavy and it is important that the correct fixings are used. If unsure, seek expert advice.

R20 Sidewinder control:

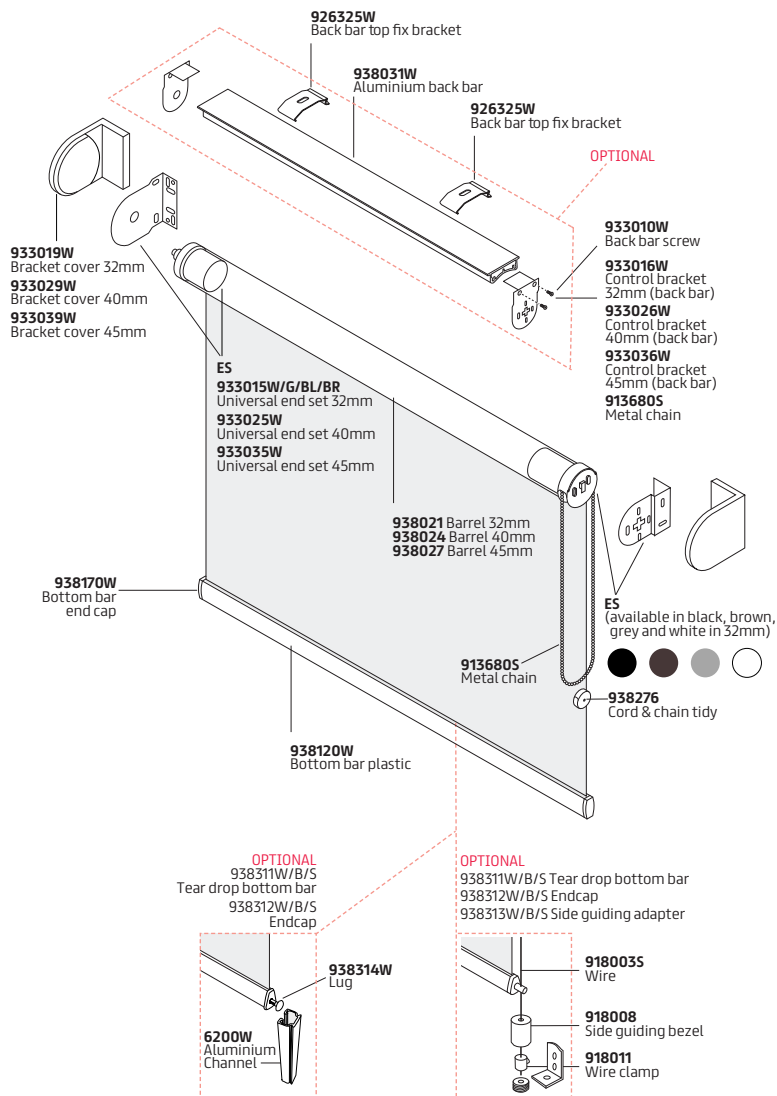

Fitting Instructions

Roller blinds (R20, Fascia, R20C, R20S, R20W)

R20 with Fascia:

N.B. This blind should be installed by a person competent in DIY. If in doubt please consult a professional.

1. If the blind is top fix, fix through the fascia profile using the indent to position the screws. If face fix, use the brackets supplied to fix the brackets securely to the wall. Once secured, fix the fascia to the brackets using the threaded screw provided.
2. Remove the chain guide from the transition plate.
3. Lifting the blind into position, secure into the transition plates.
4. Thread the chain through the chain guide and secure the chain guide in place using the screws provided.

N.B. For child safety device fitting instructions, see Point 7 on Page 5.

R20 with Fascia:

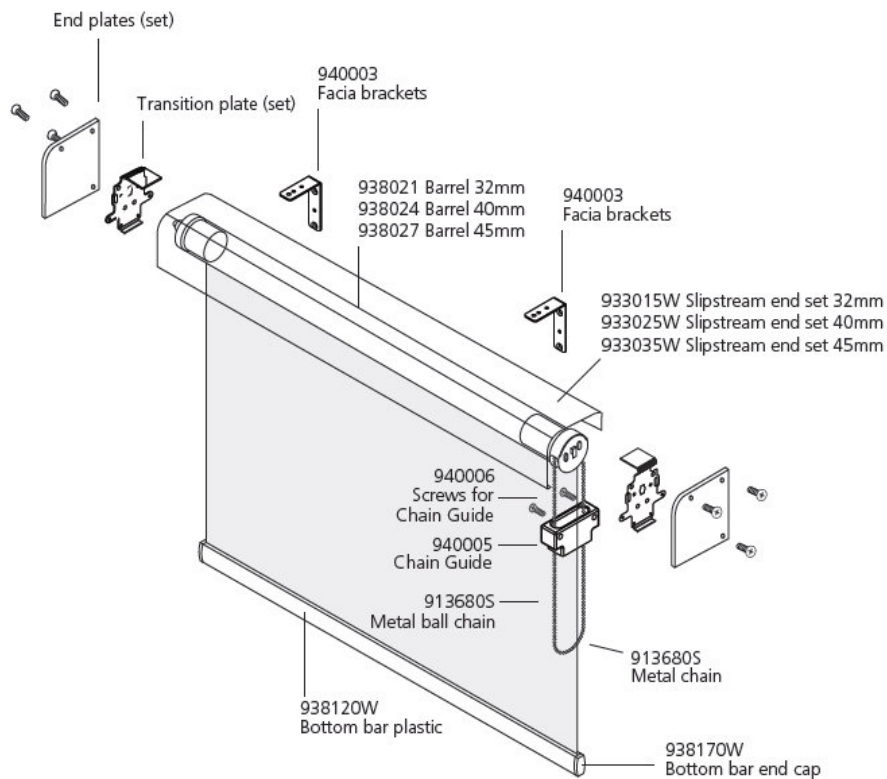

Fitting Instructions

Roller blinds (R20, Fascia, R20C, R20S, R20W)

R20C Crank Control:

N.B. This blind should be installed by a person competent in DIY. If in doubt please consult a professional.

1. The standard universal metal brackets supplied with the blind may be top, face or side-fixed.
2. Check that the blind fits correctly. The pin-end is sprung for easy fitting, but the pin should be depressed once in place. The fabric should roll off the back of the barrel, unless ordered reverse-roll.
3. Fix the control-end bracket using appropriate screws/plugs.
4. Locate the blind in the control-end bracket, and mark the position of the pin-end bracket.
5. Remove blind and fix the pin-end bracket using appropriate screws/plugs.

NB. To operate correctly, blind **MUST** be fixed level.

6. Insert the pin in the pin-end of the blind into the bracket. Press the blind against the bracket to depress sprung pin, and insert the lug on the control-end into its bracket until it drops into place.
7. Check that blind operates correctly.

NB. Large blinds are heavy and it is important that the correct fixings are used. If unsure, seek expert advice.

R20C Crank Control:

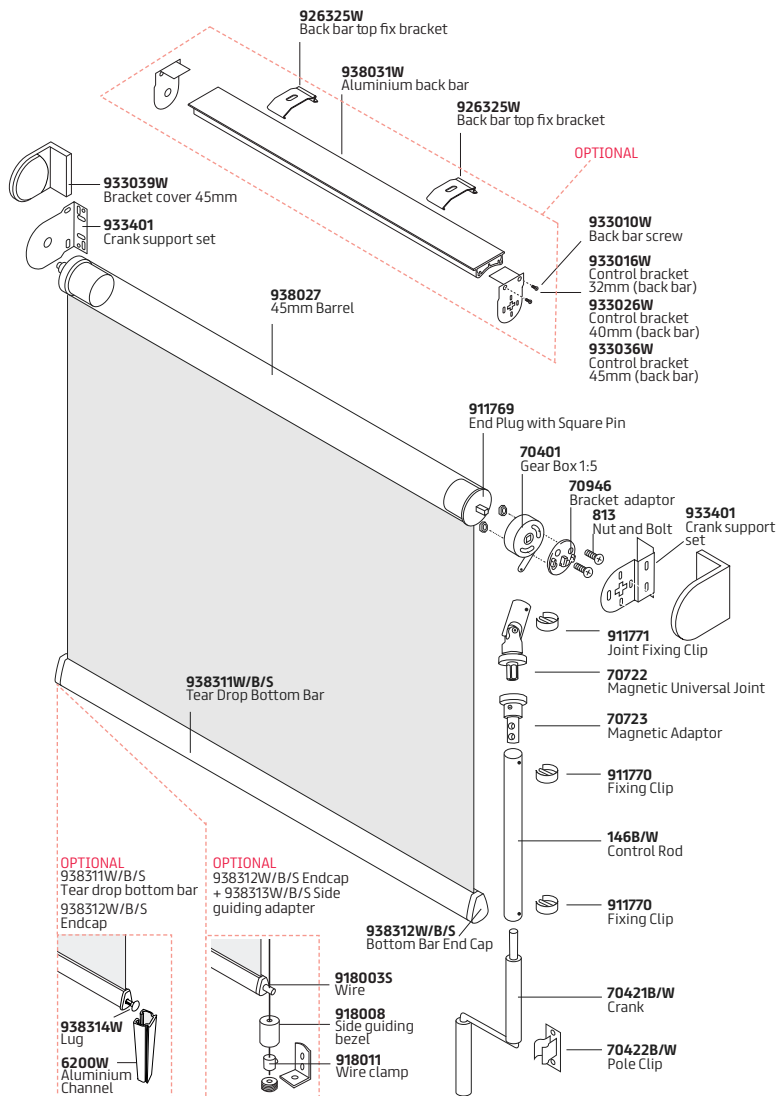

Fitting Instructions

Roller blinds (R20, Fascia, R20C, R20S, R20W)

R20S Spring Control:

N.B. This blind should be installed by a person competent in DIY. If in doubt please consult a professional.

1. Fit as per the R20 Sidewinder instructions but please see parts diagram to right (back bar is optional).
 2. Spring must be on the right-hand side unless fabric is reverse rolled.
 3. The spring would have been tensioned during the manufacturing process but the tension can be increased or decreased if required. If the fabric does not wind up completely when the blind is operated, greater spring tension can be applied as follows:
 - a) Bring the blind down 250mm from its uppermost position.
 - b) Remove the blind from the brackets and roll the fabric by hand back onto the barrel.
 - c) Replace the blind in the brackets.
 - d) If there is still not enough tension, repeat steps a to c.
 - e) If the tension is too much, follow the above but in reverse. Remove the blind from the brackets and unroll the fabric by hand. Ensure the blind is not over tensioned as it will result in the bottom bar crashing into the blind and potentially jamming. If the blind is installed outside the recess then adjusting the tension can be done without taking the blind out of its brackets if preferred. Use a flat head screwdriver through the hole in the bracket to either increase or decrease the tension as desired.
- NB.** If the blind has been fitted with a limit stop, this may need to be checked prior to installation. Roll the blind up to the desired stop point and the limit stop will be on the left (for reverse roll blinds, this will be on the right). Turn the square centre pin counter-clockwise until it stops. (On a blind in a back bar this is controlled by a cross head screw on the bracket.)
4. Attach the pull cord to the bottom bar

R20S Spring Control:

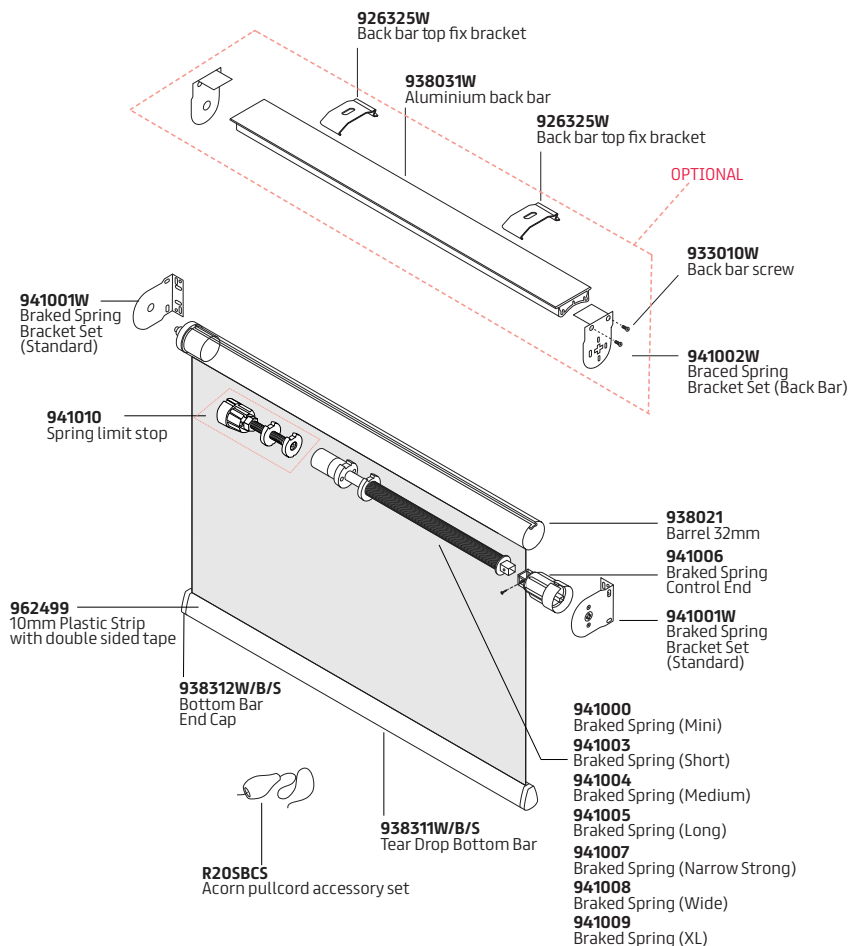

Fitting Instructions

Roller blinds (R20, Fascia, R20C, R20S, R20W)

R20W Light Duty Crank Control:

N.B. This blind should be installed by a person competent in DIY. If in doubt please consult a professional.

1. The standard universal metal brackets supplied with the blind may be top, face or side-fixed.
2. Check that the blind fits correctly. The pin-end is sprung for easy fitting, but the pin should be depressed once in place. The fabric should roll off the back of the barrel, unless ordered reverse-roll.
3. Fix the control-end bracket using appropriate screws/plugs.
4. Locate the blind in the control-end bracket, and mark the position of the pin-end bracket.
5. Remove blind and fix pin-end bracket using appropriate screws/plugs.

NB. To operate correctly, the blind **MUST** be fixed level.

6. Insert the pin in the pin-end of blind into bracket. Press the blind against the bracket to depress the sprung pin, and insert the lug on the control-end into its bracket until it drops into place.
7. Check that the blind operates correctly.

NB. Large blinds are heavy and it is important that the correct fixings are used. If unsure, seek expert advice.

R20W Light Duty Crank Control:

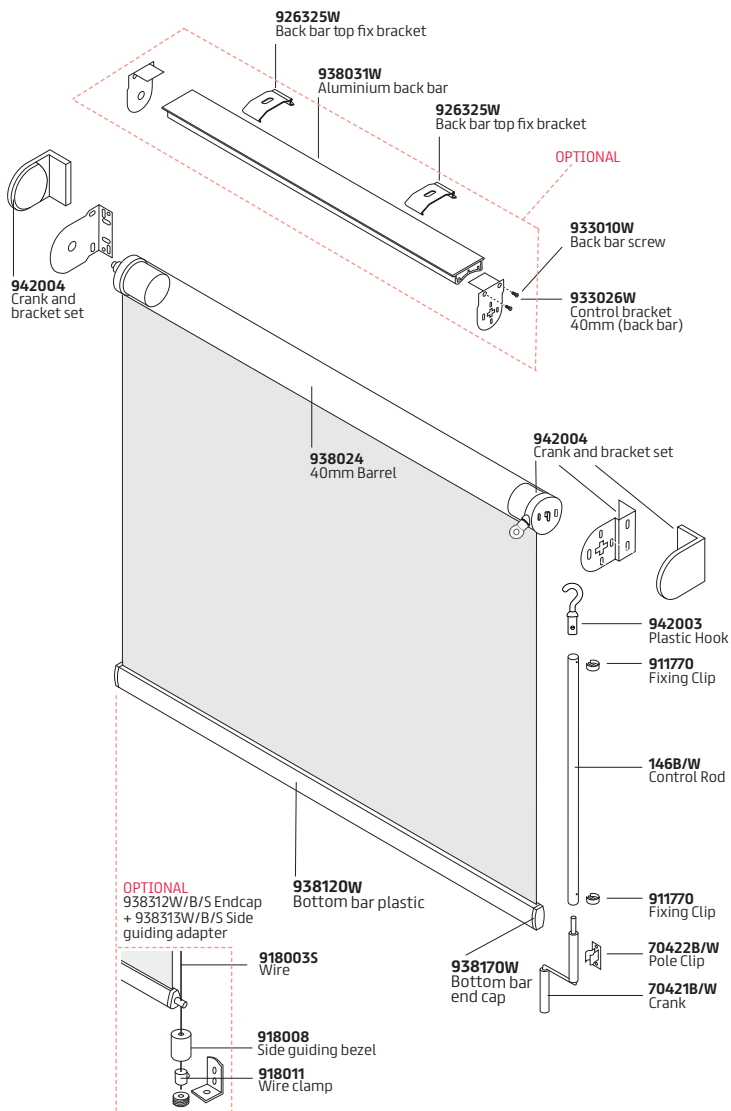



TRANSFORMING WINDOWS

Vale Blinds Direct Limited, Mulberry
House, Station Road, Bottesford,
Nottinghamshire, NG13 0EN
Call 01949 845399
Fax 0845 0090281
Email info@valeblinds.com
Visit www.valeblinds.com

For more information on all
products, please call the sales
department.