

1

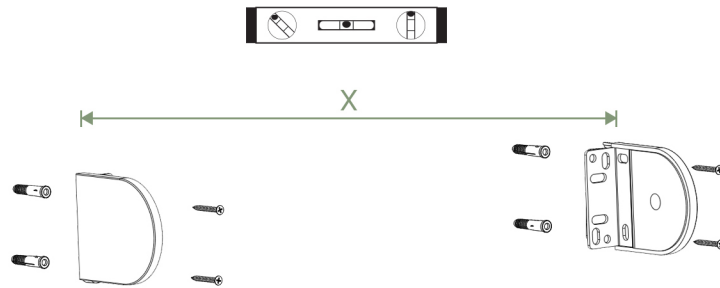

Right hand side bracket options	
	Option A 'Spring Operated'
	Option B 'Slow Rise'

2

Fitting the brackets: The left hand side bracket will be for the spring end. The right hand side bracket is for plunger end.

The plunger end bracket will be circular as shown in Option A above if you have chosen the 'Spring Operated' version. The plunger end bracket will have a cross shown in Option B above if you have chosen the 'Slow Rise' version.

Please ensure the brackets are installed level.

If your blind is the 'Spring Operated' version please skip to the next section to fit your blind.
If your blind is the 'Slow Rise' version it will be fitted with a stop - please see instruction below regarding this stop.

3

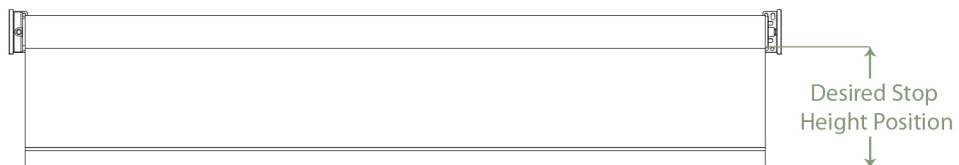

The stop on your blind is set to stop at the desired top height position
(Please see image above).

NB: If your blind is fully rolled up, this is the position that the blind will stop

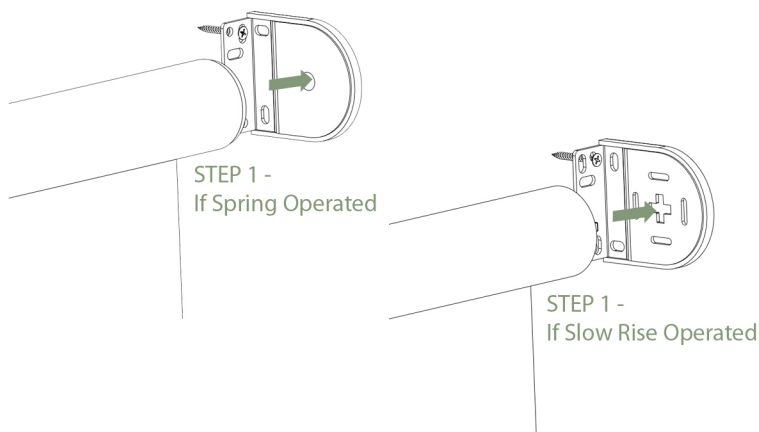

Push the plunger end into the plunger end bracket. If installed correctly this will be on the right hand side

STEP 2

4

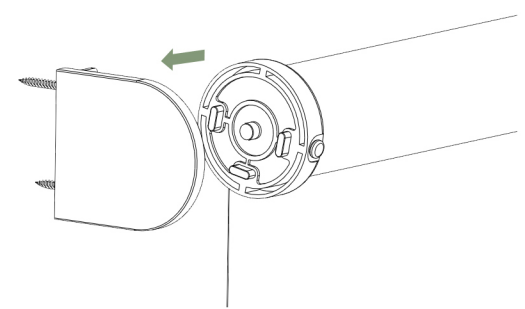

By pushing in the spring plunger into the plunger end bracket this will enable the spring end to fit in the cross on the opposite bracket. Please ensure that the locating lugs are in the lowest position as shown above

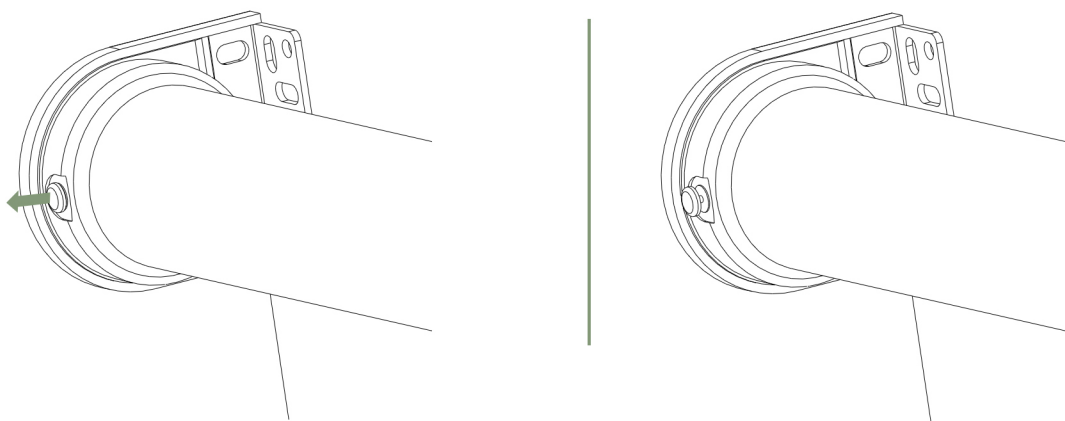

5

Your blind is pre tensioned and ready to operate once you release the locating pin as shown above. Please take care **not** to pull the pin all the way out from the front side of the spring. Pull to operate and stop the blind in the desired location

Changing your fabric: Pull blind down to expose hook on the barrel. The locating pin may be pushed in at this point to ensure that the spring does not lose its tension. Please ensure you do not roll the blind out too far, as the fabric may disengage from the tube your blind will lose tension. Once you have your fabric changed release the locating pin and operate the blind, taking care that the fabric does not disengage from the tube at this stage.

6

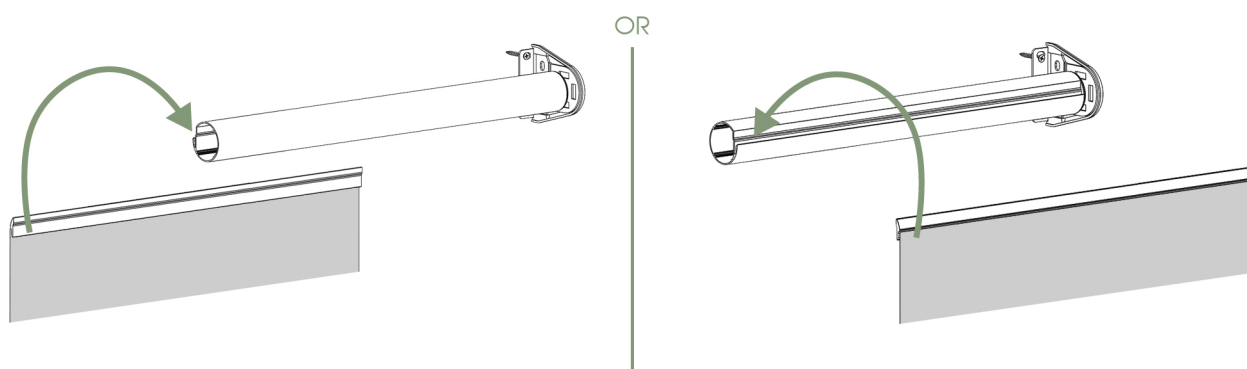

Lost tension in the spring:

A

- 1) Pull the blind down to the drop
- 2) Please then ensure the front locating pin is IN.
- 3) Gently remove the blind from the brackets by pushing in the plunger end to allow the spring end to remove from the bracket with the cross
- 4) Roll the blind back up by hand, and replace it back into the brackets
- 5) Release the pin and test the blind to see if operates correctly
- 6) If not please repeat previous steps until operating correctly

Lost top position:

If the blind has lost its top position and the fabric is not stopping at the desired top height position it can be reset

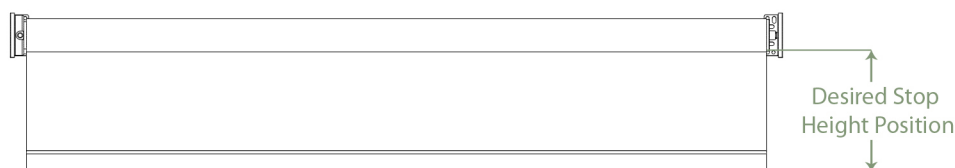

B

- 1) Lock the blind at the desired top height position (see above) and insert the locating pin IN
- 2) Gently remove the blind from the brackets by pushing in the plunger end, to allow the spring end to remove from the bracket with the cross.
- 3) Turn the spring plunger end clockwise until it stops. (see right)
- 4) Replace the blind back into the brackets and operate. The blind will stop at the desired top location.

