

MEASURING

4

4.1 MEASURE METHODS

Innovative adhesive mounting method, without drilling.
Suitable for PVC, aluminium and wooden window frames.

All window frames are categorized into three methods of measure:

Method A (Window frame with a window rubber/seal smaller or equals $\leq 5\text{mm}$)

Method B (Window frame with a window rubber/seal wider than $> 5\text{ mm}$ and a rubber/seal depth smaller or equals $\leq 5\text{mm}$)

Method C (Window frame with a window rubber/seal wider than $> 5\text{ mm}$ and a rubber/seal depth larger than $> 5\text{mm}$)

Measure on all sides; width top and bottom; height left and right to determine smallest sizes.

For most common windows with **PVC** frame measure method A see page 4-3 to 4-4

For most common windows with **Wooden** frame measure method A see page 4-5 to 4-6

For most common windows with **Aluminium** frame method B or C see page 4-7 to 4-9

4.2 MEASURE METHOD A MOST COMMON FOR WINDOWS WITH PVC FRAME

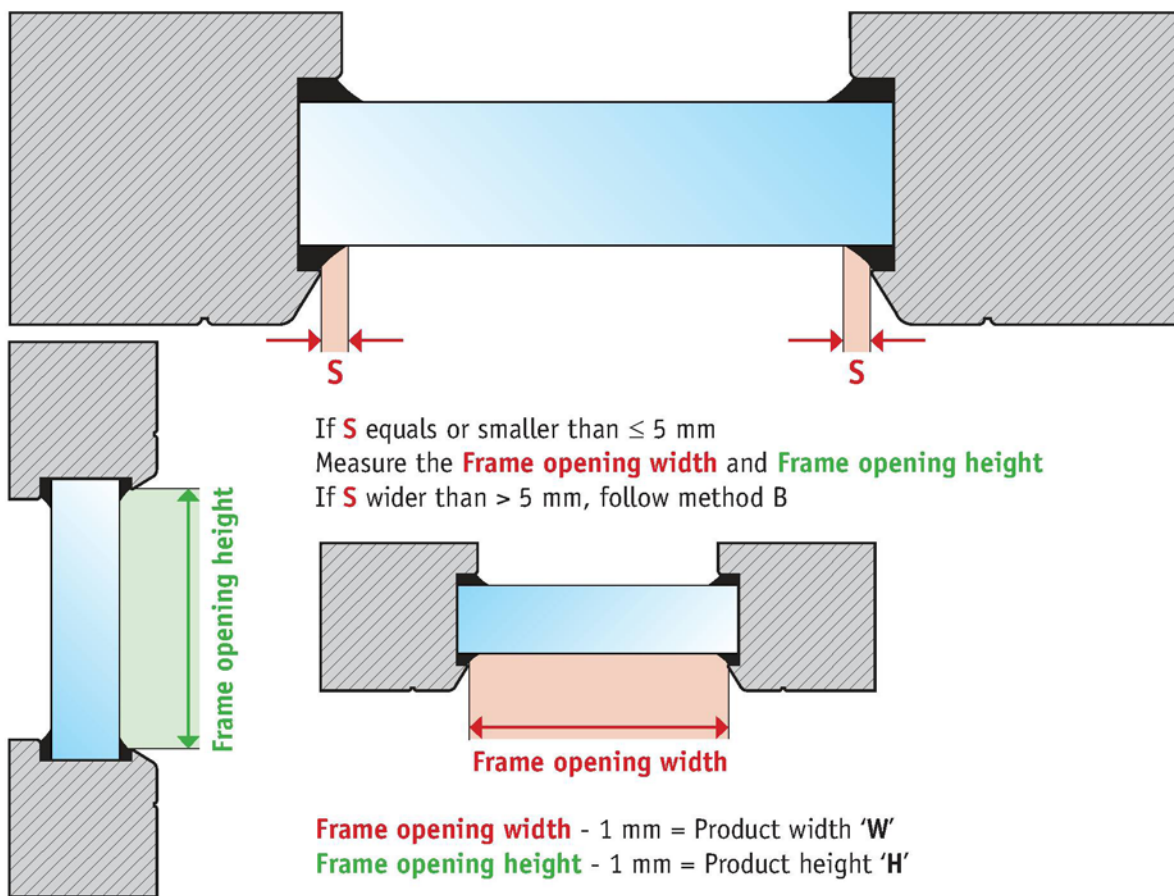

Example; mounted c-profile onto glass

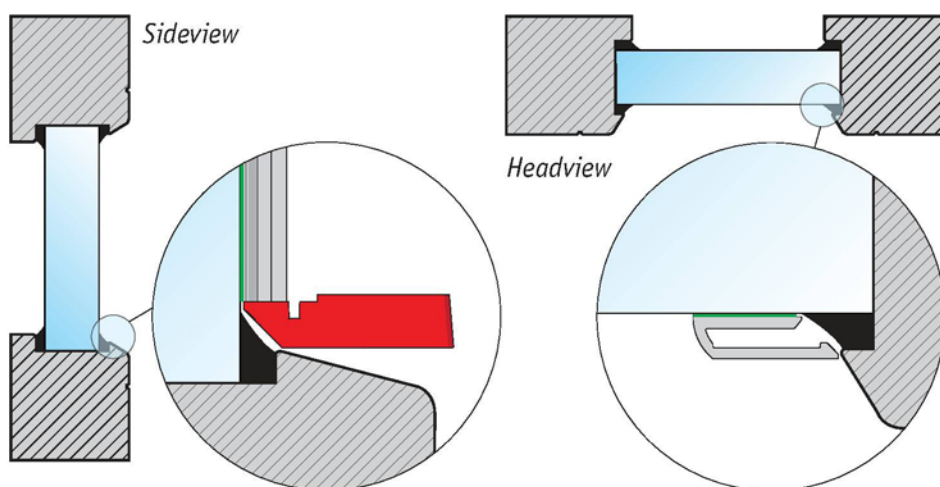

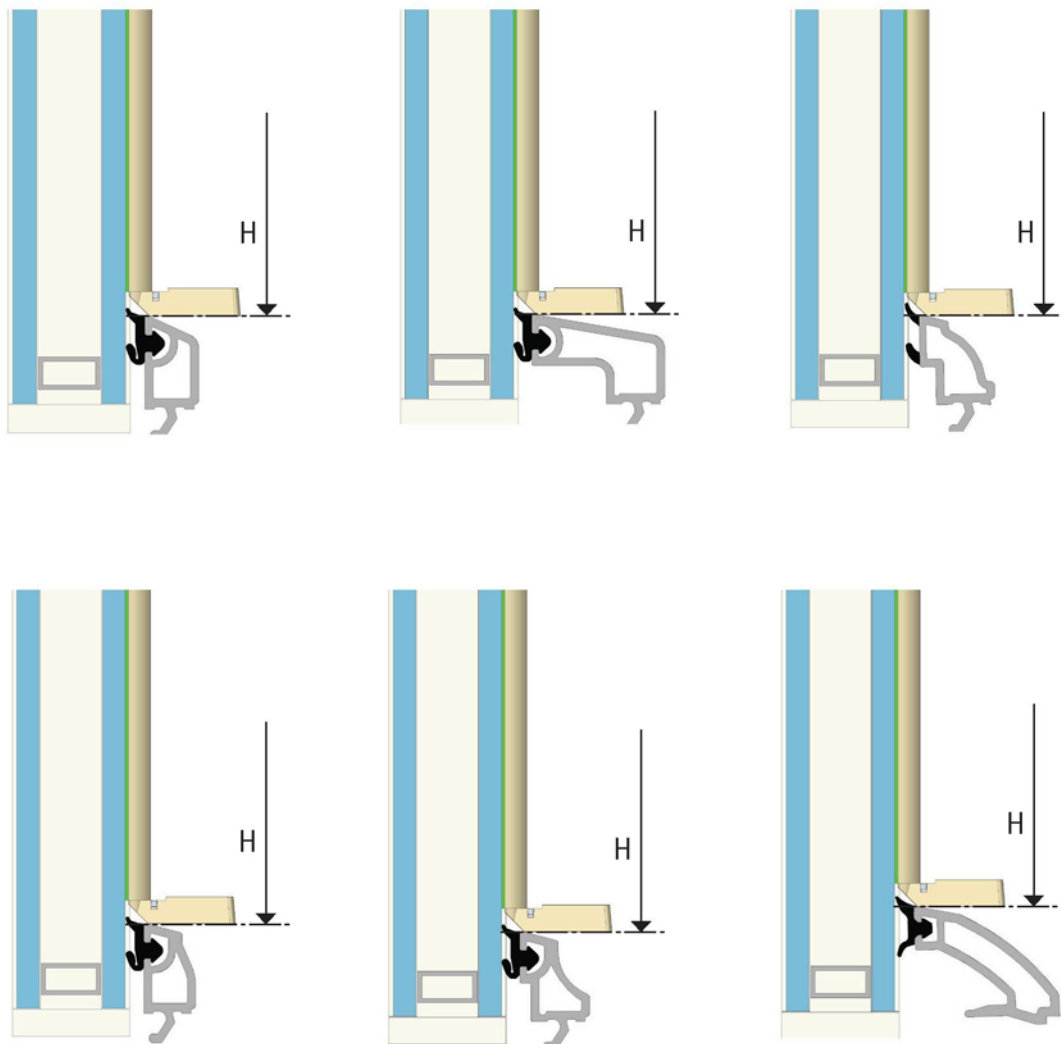
4.3 EXAMPLES PVC BEADINGS WITH RUBBER SEAL ≤ 5 MM

4.4 MEASURE METHOD A MOST COMMON FOR WINDOWS WITH WOODEN FRAME

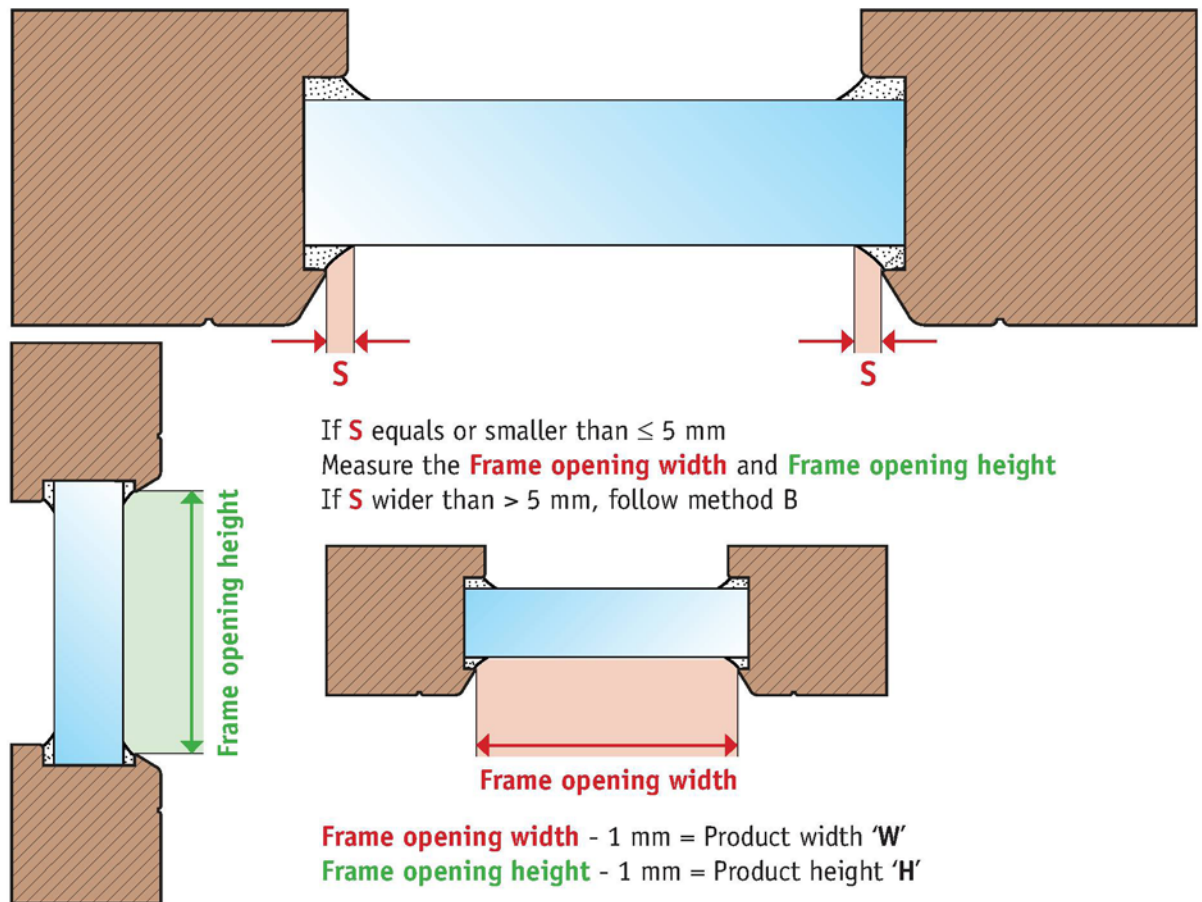

Example; mounted c-profile onto glass

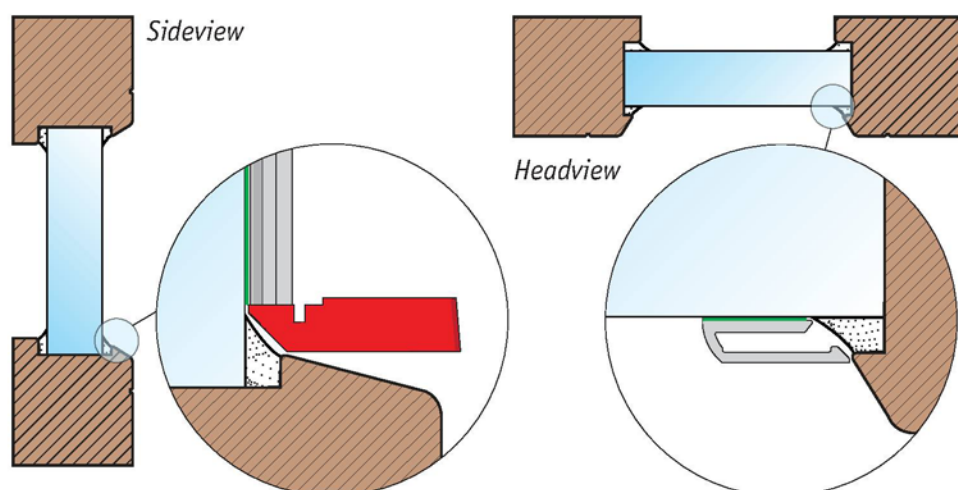

4.5 **EXAMPLE WOOD BEADING**

Page date: 22-04-2015

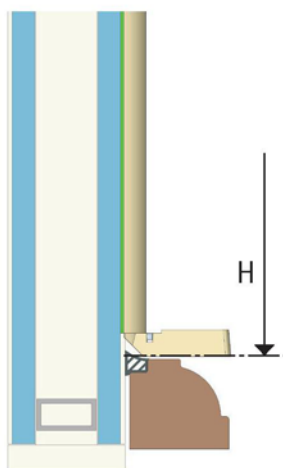

4.6 MEASURE METHOD B MOST COMMON FOR WINDOWS WITH ALUMINIUM FRAME

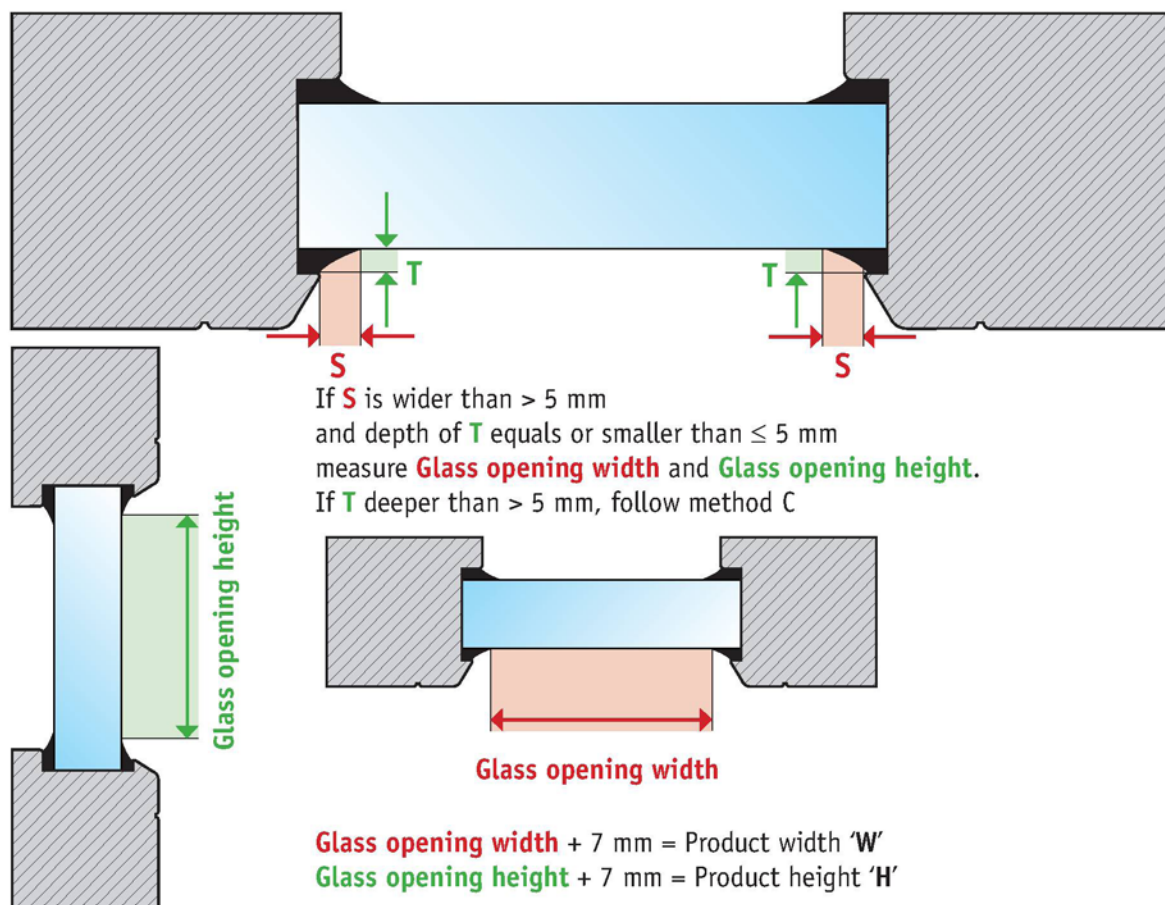

Example; mounted c-profile onto glass

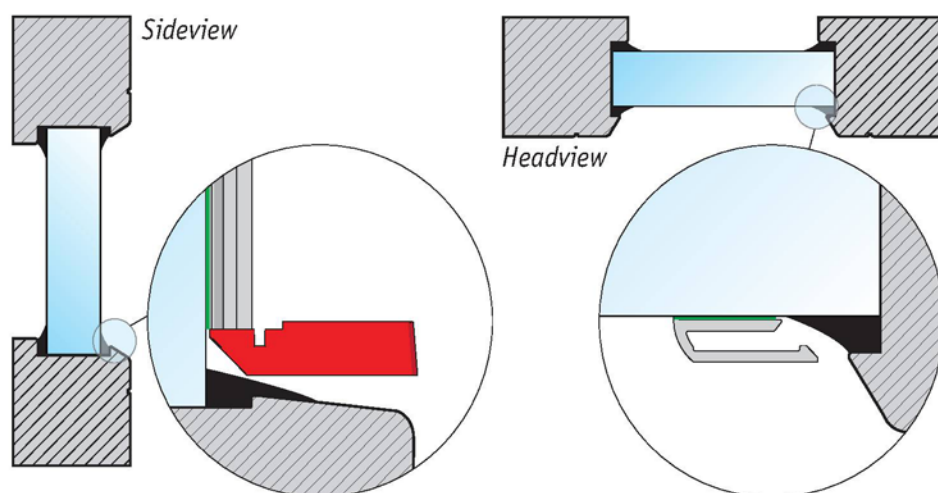

4.7 EXAMPLE METHOD B ALUMINIUM BEADING

Page date: 19-05-2015

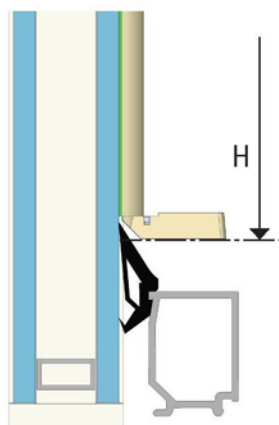

4.8 MEASURE METHOD C MOST COMMON FOR WINDOWS WITH ALUMINIUM FRAME

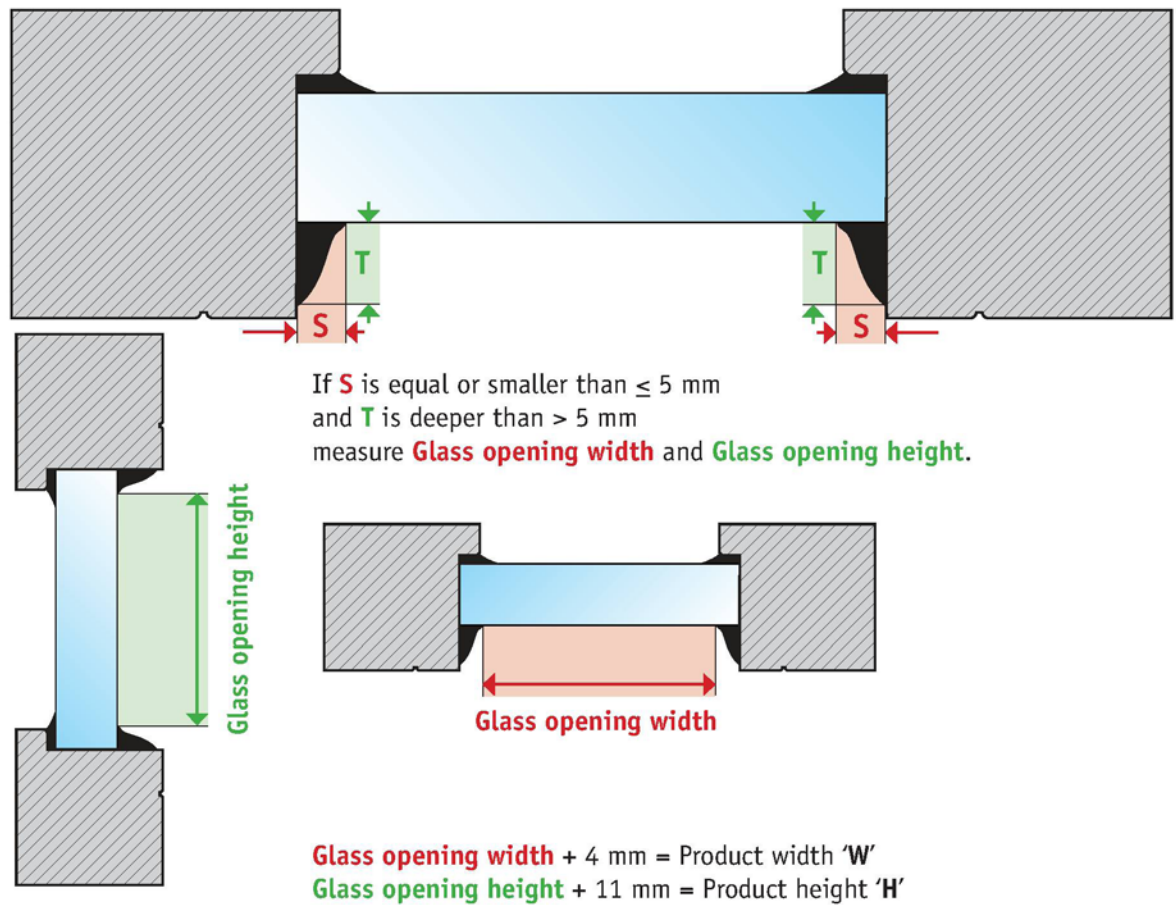

Example; mounted c-profile onto glass

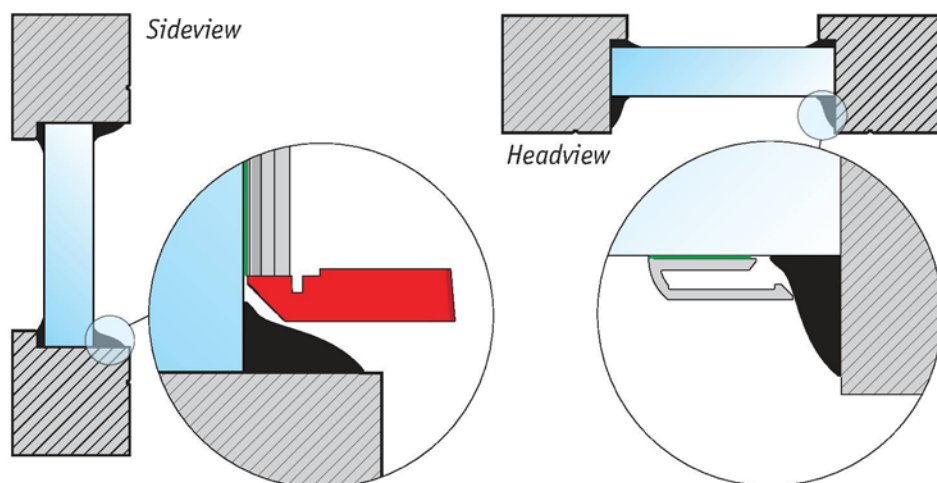

4.9 EXAMPLE METHOD C ALUMINIUM BEADING

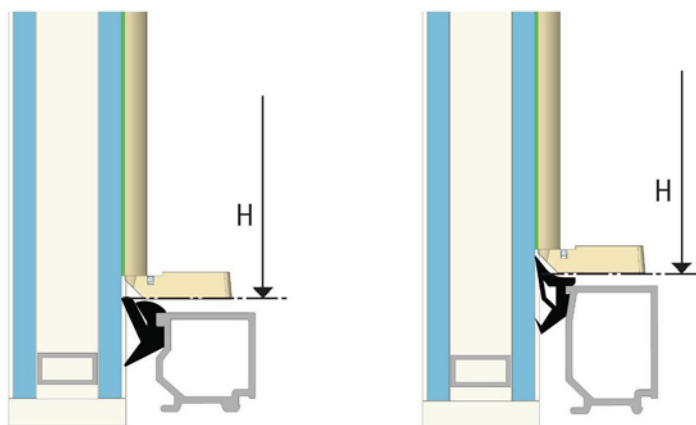

OnFace installation

Do not damage the product when using a sharp knife to open the packaging!

Model
BB32-A2

Cleaning Wipe NB
(246536)

Optional. If silicone is used on window or in room use the Tape Primer Anti-silicone.
(246545)

